

## Top Navigation

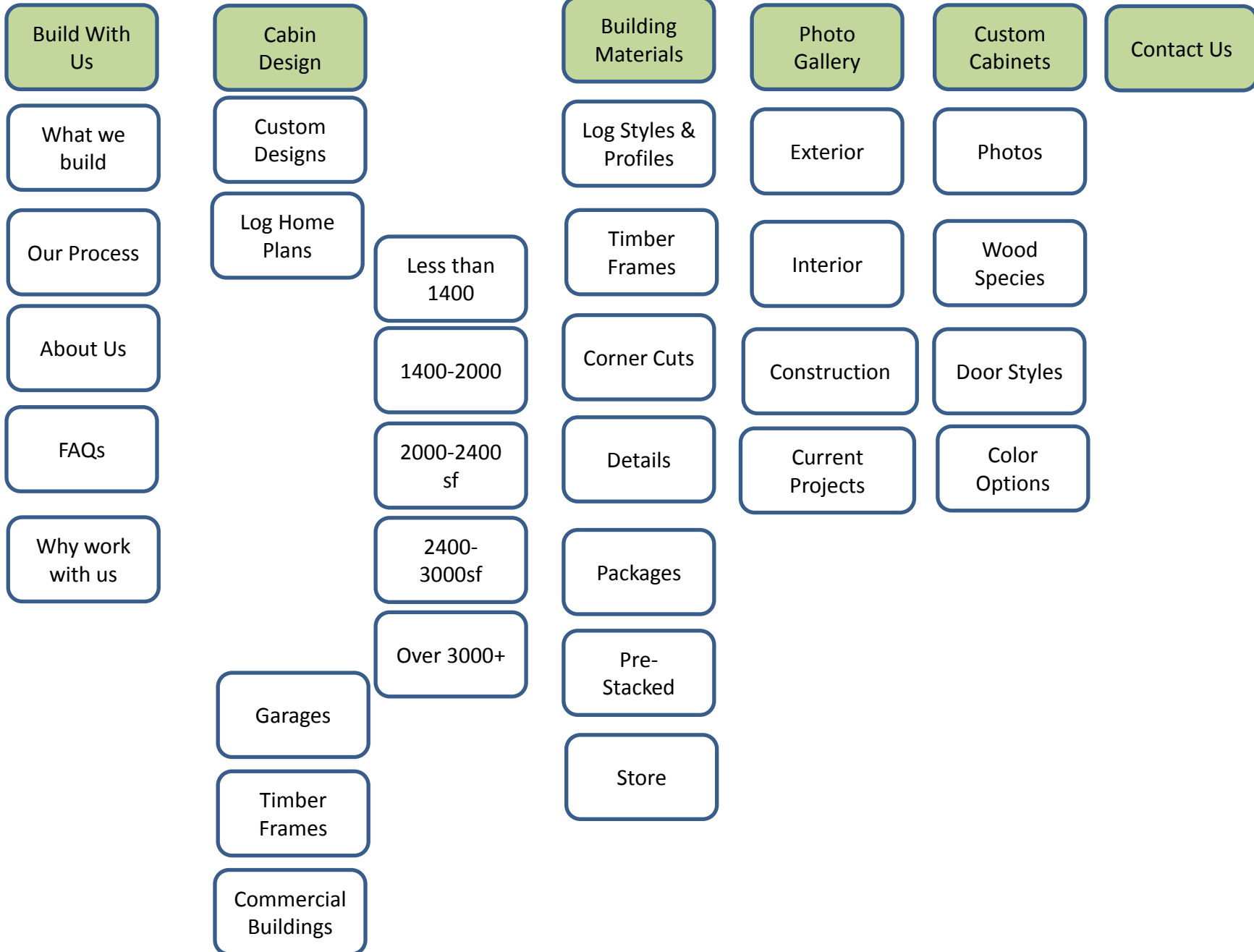

Homepage

This box will be on every page and will click through to the appropriate Log Homes Plan page

#### View Plans by size:

[Less than 2000](#)[2000-2400](#)[2500- 3000](#)[3000-3500](#)[3500-4000 +](#)[Garages](#)

**Featured Plan:** View the Pine Grove



#### What We Build

Work with our design team to create a design you will love.

[Read more](#)

#### Our Process

This who we are and what we do. We love log homes and this is why we do it.

[Read more](#)

**Article:** How to select the building site for your new log home

**Article:** Design and Build your Dream Log Home with a Shrinking Budget

#### About World Outdoors



#### Award Winning Plans



#### Photo Gallery



#### View Plans by size:

[Less than 2000](#)[2000-2400](#)[2500- 3000](#)[3000 +](#)[Commercial](#)[Garages](#)

#### Featured Plan: View the Pine Grove



#### Custom Design

Work with our design team to create a design you will love.

[Read more](#)

#### Managing Waste



#### Experience



#### Effective Sourcing



#### Why Call Us

This who we are and what we do. We love log homes and this is why we do it.

[Read more](#)[Article: How to select the building site for your new log home](#)[Article: Design and Build your Dream Log Home with a Shrinking Budget](#)

#### What's New at World Outdoors



#### Award Winning Plans



#### Photo Gallery



This will not normally be visible on any page. When the user clicks the “contact us” button this will appear, scrolling up from the bottom of the page and cover the bottom part of the initially visited page.

Contact Us X

**Contact Us**

World Outdoors  
Log Homes

PO Box 2128  
Marion, NC 28752  
888-LOG-8300

Name

Email

Message

Submit

Bottom Contact us  
button

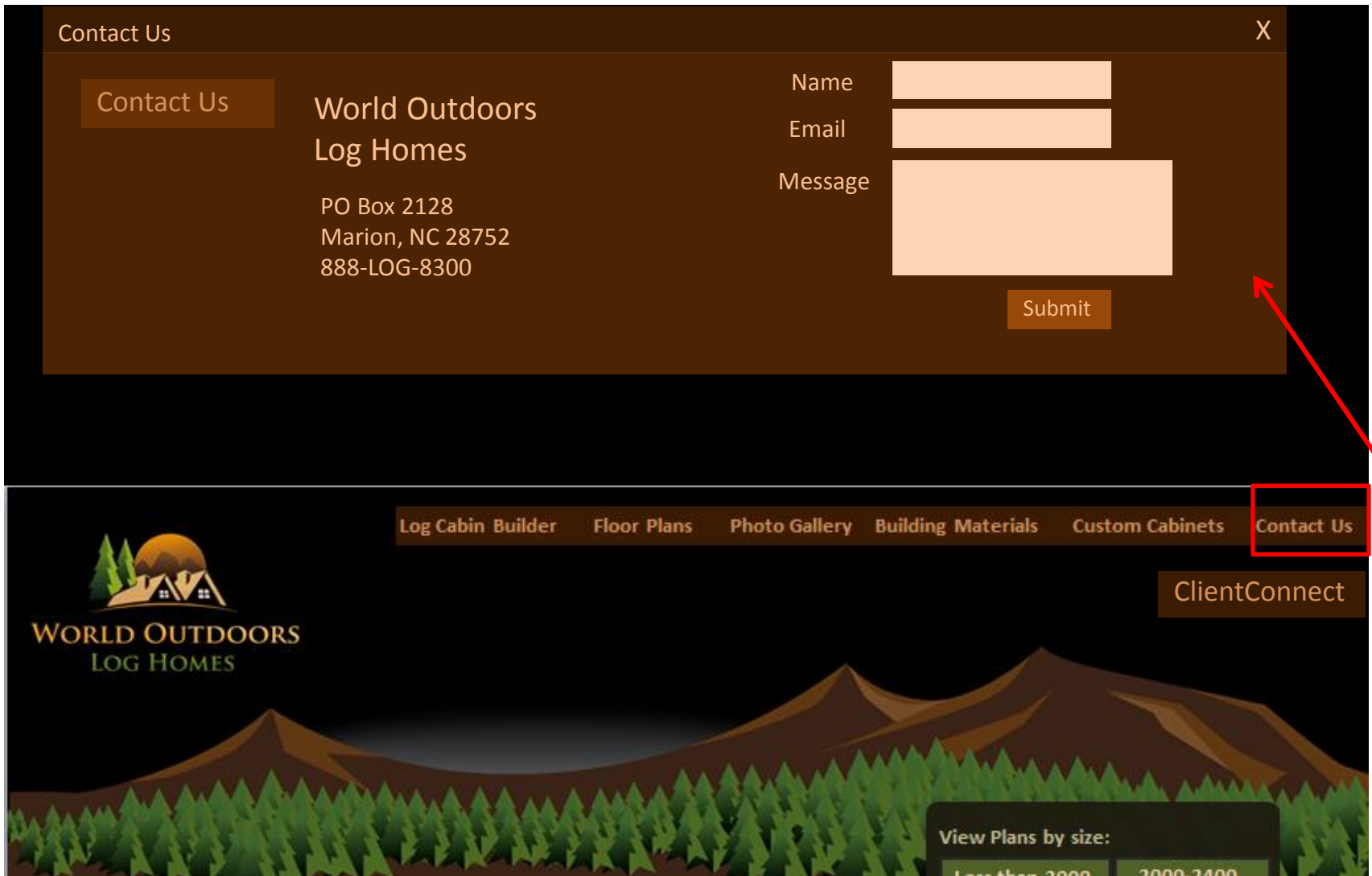

Top Contact us button

Log Cabin Builder Section  
(See top Nav and see Slide 1)



[Build With Us](#) > [What We Build](#)

[What We Build](#)

[Our Process](#)

[About Us](#)

[FAQs](#)

[Articles](#)

[Why Work  
With Us](#)

## What We Build

Lorem ipsum dolor sit amet, consectetur adipiscing elit. Quisque consectetur, diam sit amet vestibulum tempor, erat dui aliquet lacus, vel elementum sapien lacus eu diam. Suspendisse fringilla sollicitudin nulla nec posuere. Nunc quis leo fermentum tellus scelerisque aliquam ac a magna. Morbi vitae enim felis.

This who we are and what we do. We love log homes and this is why we do it. Lorem ipsum dolor sit amet, consectetur adipiscing elit. Quisque consectetur, diam sit amet vestibulum tempor, erat dui aliquet lacus, vel elementum sapien lacus eu diam. Suspendisse fringilla sollicitudin nulla nec posuere. Nunc quis leo fermentum tellus scelerisque aliquam ac a magna. This who we are and what we do. We love log homes and this is why we do it. Lorem ipsum dolor sit amet,

### View Plans by size:

[Less than 1400](#)

[1400-2000](#)

[2000- 2400](#)

[2400-3000](#)

[3000 +](#)

[Garages](#)





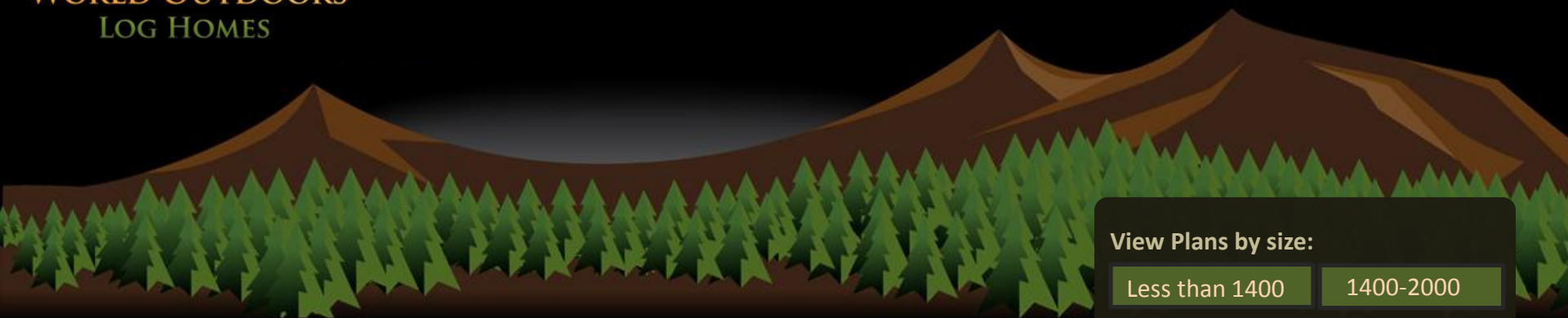

View Plans by size:

Less than 1400	1400-2000
2000- 2400	2400-3000
3000 +	Garages

Build With Us > Our Process

- What We Build
- Our Process
- About Us
- FAQs
- Articles
- Why Work With Us

Plan



Contract



Finance

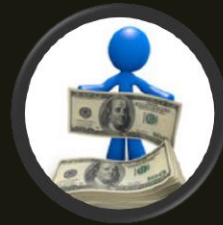

Build



Meet

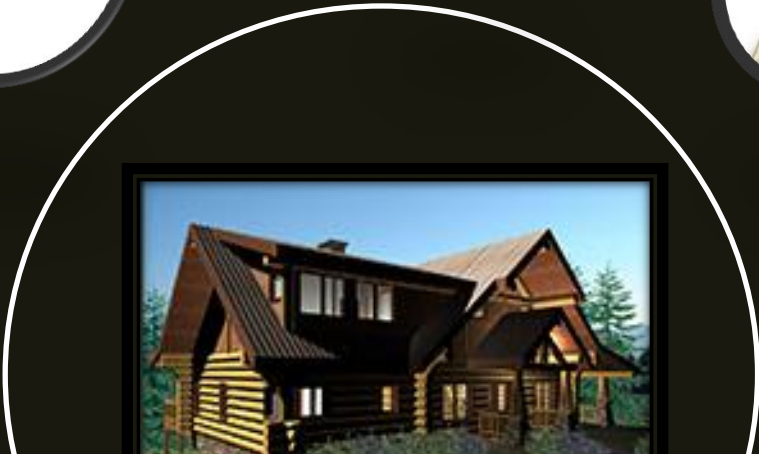

all circles  
, meet, plan,  
d the arrow

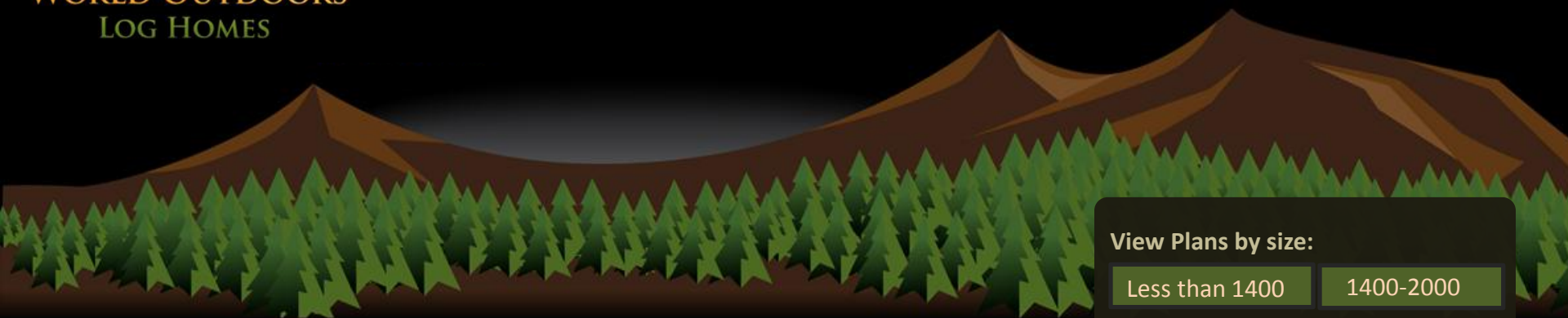

View Plans by size:

Less than 1400	1400-2000
2000- 2400	2400-3000
3000 +	Garages

Build With Us > Our Process > Meet

What We Build

Our Process

About Us

FAQs

Articles

Why Work  
With Us

Meet



Lorem ipsum dolor sit amet, consectetur adipiscing elit.  
Quisque consectetur, diam sit amet vestibulum tempor, erat



Pic of our  
office



s the template  
for “Our  
ss” each  
(Meet, Plan,  
act etc will

[Build With Us](#) > [About Us](#)

[What We Build](#)

[Our Process](#)

[About Us](#)

[FAQs](#)

[Articles](#)

[Why Work  
With Us](#)

## About Us

Lorem ipsum dolor sit amet, consectetur adipiscing elit. Quisque consectetur, diam sit amet vestibulum tempor, erat dui aliquet lacus, vel elementum sapien lacus eu diam. Suspendisse fringilla sollicitudin nulla nec posuere. Nunc quis leo fermentum tellus scelerisque aliquam ac a magna. Morbi vitae enim felis.

This who we are and what we do. We love log homes and this is why we do it. Lorem ipsum dolor sit amet, consectetur adipiscing elit. Quisque consectetur, diam sit amet vestibulum tempor, erat dui aliquet lacus, vel elementum sapien lacus eu diam. Suspendisse fringilla sollicitudin nulla nec posuere. Nunc quis leo fermentum tellus scelerisque aliquam ac a magna. This who we are and what we do. We love log homes and this is why we do it. Lorem ipsum dolor sit amet,

### View Plans by size:

[Less than 1400](#)

[1400-2000](#)

[2000- 2400](#)

[2400-3000](#)

[3000 +](#)

[Garages](#)





[Build With Us](#) > [FAQs](#)

[What We Build](#)

[Our Process](#)

[About Us](#)

[FAQs](#)

[Articles](#)

[Why Work  
With Us](#)

## FAQs

Q: What is ClientConnect and how do we stay in touch with you throughout the building process?

A: Lorem ipsum dolor sit amet, consectetur adipiscing elit. Quisque consectetur, diam sit amet vestibulum tempor, erat dui aliquet lacus, vel elementum sapien lacus eu diam. Suspendisse fringilla sollicitudin nulla nec posuere. Nunc quis leo fermentum tellus scelerisque aliquam ac a magna. Morbi vitae enim felis.

Q: Lorem ipsum dolor sit amet, consectetur adipiscing elit.?

A: Lorem ipsum dolor sit amet, consectetur adipiscing elit. Quisque consectetur, diam sit amet vestibulum tempor, erat dui aliquet lacus, vel elementum sapien lacus eu diam. Suspendisse fringilla sollicitudin nulla nec posuere. Nunc quis leo fermentum tellus scelerisque aliquam ac a magna. Morbi

### View Plans by size:

[Less than 1400](#)

[1400-2000](#)

[2000- 2400](#)

[2400-3000](#)

[3000 +](#)

[Garages](#)



[Build With Us](#) > [Articles](#)

[What We Build](#)[Our Process](#)[About Us](#)[FAQs](#)[Articles](#)[Why Work  
With Us](#)

## Articles

### About smaller homes...

Within the last half century, North American homes have more than doubled in size becoming castles to impress by volume alone.

Real estate agents define a home by it square footage, number of bedrooms and bathrooms and pictures of luxuriously furnished formal living and dining rooms that are left unused by its occupants. Due to high building and energy costs, dwindling investments, savings and pensions and an emerging consciousness not to waste and embrace “green concepts”, designing a home is now much less about impressing our neighbors and friends with size and wow factor.

### View Plans by size:

[Less than 1400](#)[1400-2000](#)[2000- 2400](#)[2400-3000](#)[3000 +](#)[Garages](#)

### Related Articles

[Log Homes \(4\)](#)[Small Homes \(2\)](#)

### Read More Articles

[Universal design for log](#)

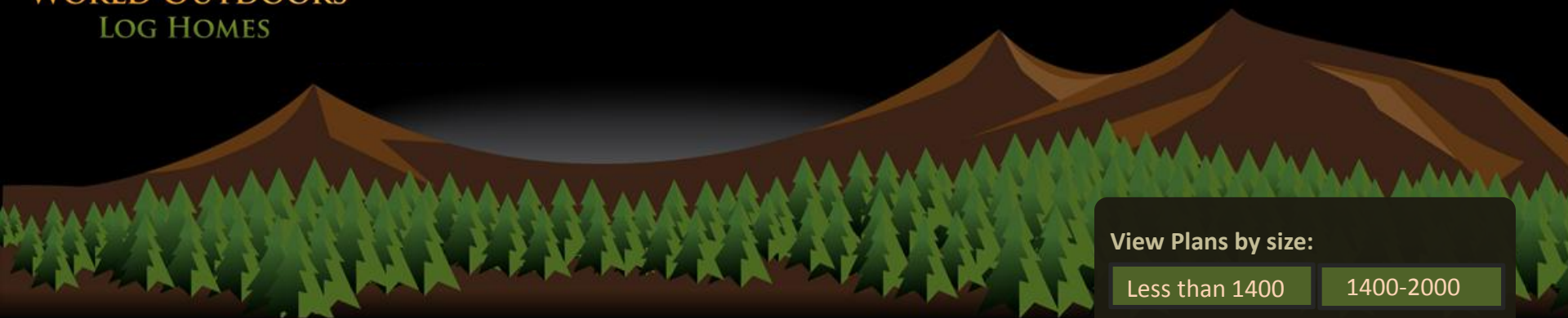

**View Plans by size:**

Less than 1400	1400-2000
2000- 2400	2400-3000
3000 +	Garages

Build With Us > Why Work With Us

What We Build

Our Process

About Us

FAQs

Articles

Why Work  
With Us

**Low Overhead**



**Experience**



**Effective Sourcing**



**Managing Waste**



View a demo of our ClientConnect Portal to see how we stay in touch with you every step of the way throughout the entire building process.

**Our Team Has a Combined 30 Years of Building Experience**

Lorem ipsum dolor sit amet, consectetur adipiscing elit. Quisque consectetur, diam sit amet vestibulum tempor, erat dui aliquet lacus vel elementum con...

will be 6 images  
top row that  
slowly on a 2

1  
2  
3  
4



## Cabin Design Section (See top Nav and see Slide 1)

Note on menu structure: There are 3 sections with submenus (Log Plans, Timber Frame, Rustic Inspired). When someone clicks into the section from the top menu, the side menu defaults to Custom Design with Log Home Plans submenu open. If user clicks on one of the other sections with submenus, that submenu opens and the other one closes. If user clicks on a button with no submenu, the submenu that is currently selected remains open. If user clicks on Garages, the “All Plans” submenu item opens, but it does not affect other submenus.

#### View Plans by size:

[Less than 2000](#)
[2000-2400](#)
[2500- 3000](#)
[3000 +](#)
[Commercial](#)
[Garages](#)

#### Cabin Designs > Custom Design Process

##### Custom Design

##### Log Home Plans

[▶ Less than 1400](#)
[▶ 1400-2000](#)
[▶ 2000-2400](#)
[▶ 2400-3000](#)
[▶ Over 3000](#)
[Garages](#)
[Timber Frames](#)
[Rustic Inspired](#)
[Commercial](#)

#### Post and Beam, Timber Frame and Log Home Floor Plans

Welcome to our extensive floor plans gallery. If you are having a difficult time deciding what type of home you want, browsing through



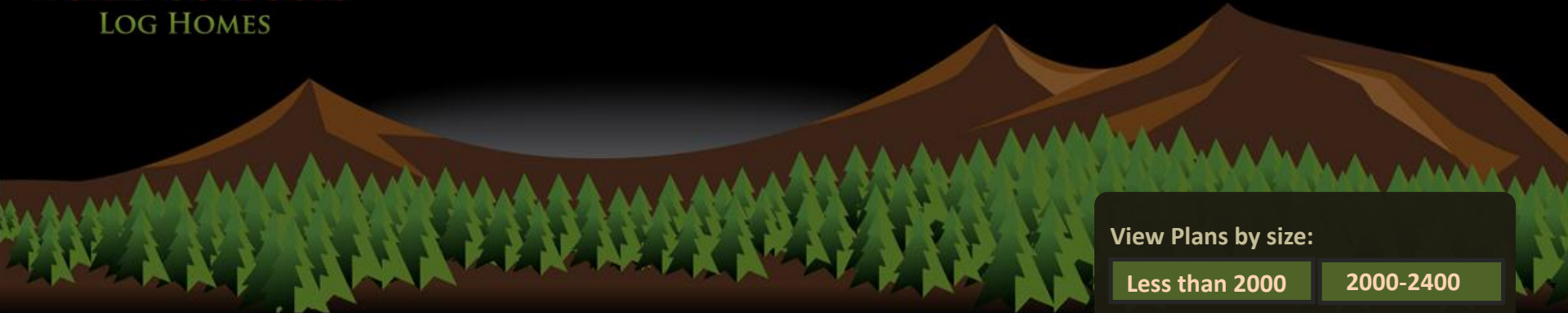

View Plans by size:

- |                |           |
|----------------|-----------|
| Less than 2000 | 2000-2400 |
| 2500- 3000     | 3000 +    |
| Commercial     | Garages   |

Cabin Designs > Log Home Plans

- Custom Design
- Log Home Plans
- ▶ Less than 1400
- ▶ 1400-2000
- ▶ 2000-2400
- ▶ 2400-3000
- ▶ Over 3000
- Garages
- Timber Frames
- Commercial Buildings



Log Home Floor Plans

Welcome to our extensive floor plans gallery. If you are having a difficult time deciding what type of home you want, browsing through





## Cabin Designs > Log Home Plans > 1400-2000 sq ft

[Custom Design](#)
[Log Home Plans](#)
[▶ Less than 1400](#)
[▶ 1400-2000](#)
[▶ 2000-2400](#)
[▶ 2400-3000](#)
[▶ Over 3000](#)
[Garages](#)
[Timber Frames](#)
[Rustic Inspired](#)
[Commercial](#)

Greece 1656 sq.ft.



Long Island 1661 sq.ft.



Clearwater 1670 sq.ft.



### View Plans by size:

[Less than 2000](#)
[2000-2400](#)
[2500- 3000](#)
[3000 +](#)
[Commercial](#)
[Garages](#)

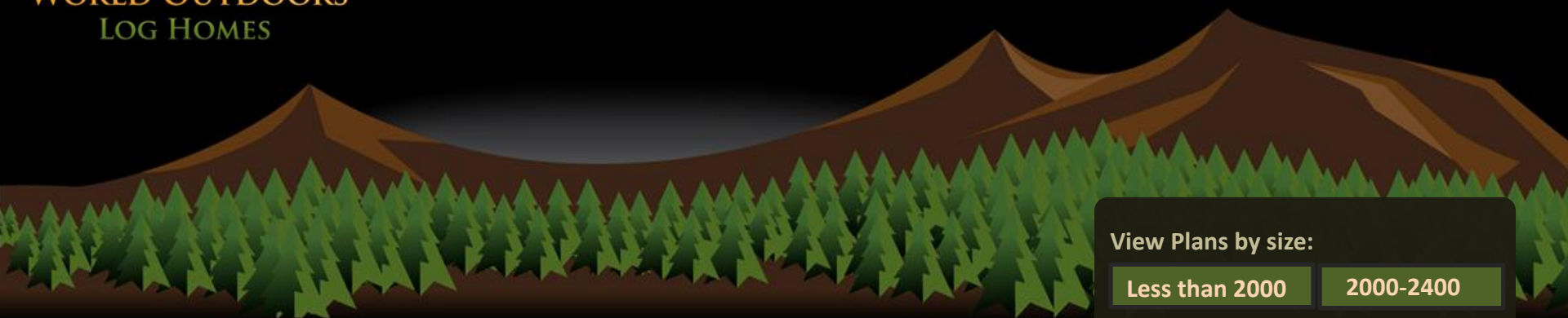

View Plans by size:

Less than 2000	2000-2400
2500- 3000	3000 +
Commercial	Garages

Cabin Designs > Log Home Plans

- Custom Design
- Log Home Plans
  - Less than 1400
  - 1400-2000
  - 2000-2400
  - 2400-3000
  - Over 3000
- Garages
- Timber Frames
- Rustic Inspired
- Commercial



Description of Plan

Lorem ipsum dolor sit amet, consectetur adipiscing elit. Quisque consectetur, diam sit amet vestibulum tempor, erat qui aliquet lacus,





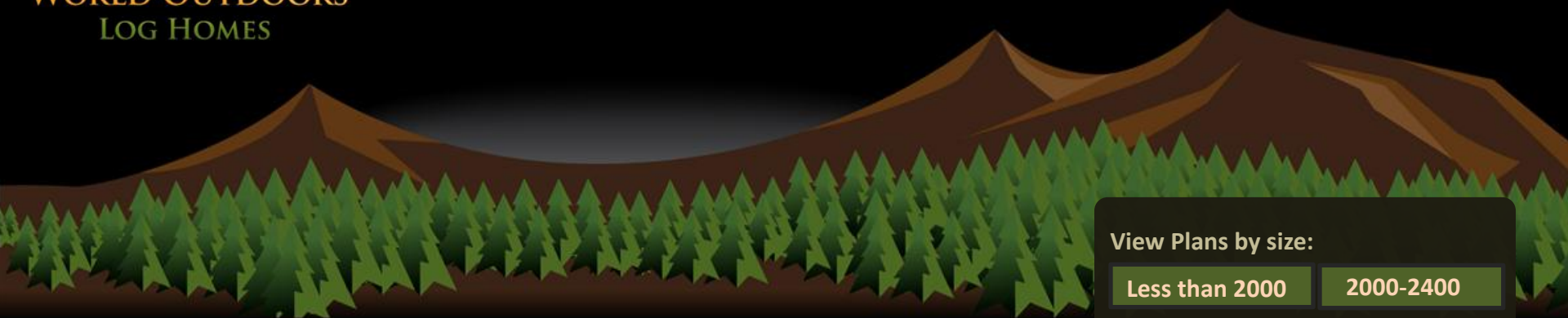

View Plans by size:

Less than 2000	2000-2400
2500- 3000	3000 +
Commercial	Garages

Cabin Designs > Garages

- Custom Design
- Log Home Plans
- ▶ Less than 1400
- ▶ 1400-2000
- ▶ 2000-2400
- ▶ 2400-3000
- ▶ Over 3000
- Garages
- ▶ All Plans
- Timber Frames
- Rustic Inspired



Garages

Welcome to our extensive floor plans gallery. If you are having a





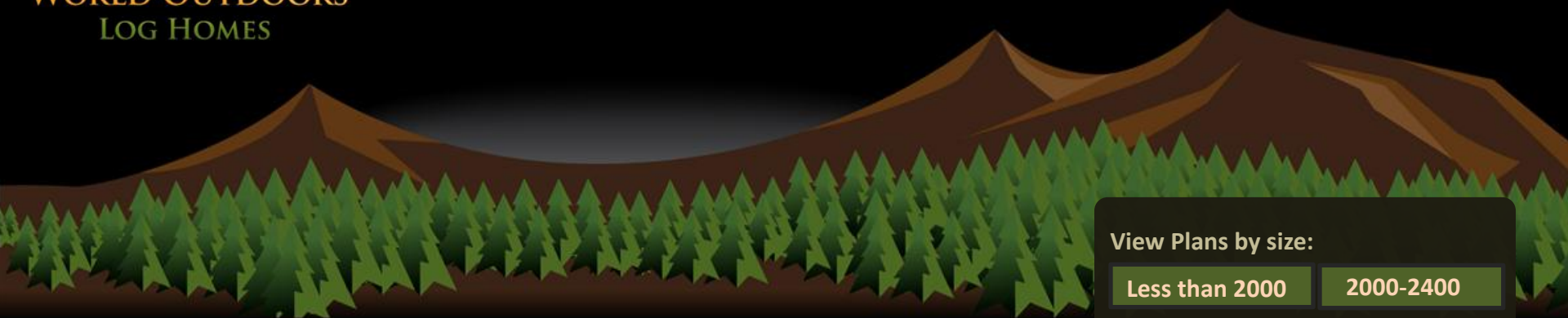

View Plans by size:

- |                |           |
|----------------|-----------|
| Less than 2000 | 2000-2400 |
| 2500- 3000     | 3000 +    |
| Commercial     | Garages   |

Cabin Designs > Garages > All Plans

- Custom Design
- Log Home Plans
- ▶ Less than 1400
- ▶ 1400-2000
- ▶ 2000-2400
- ▶ 2400-3000
- ▶ Over 3000
- Garages
- ▶ All Plans
- Timber Frame
- Rustic Inspired



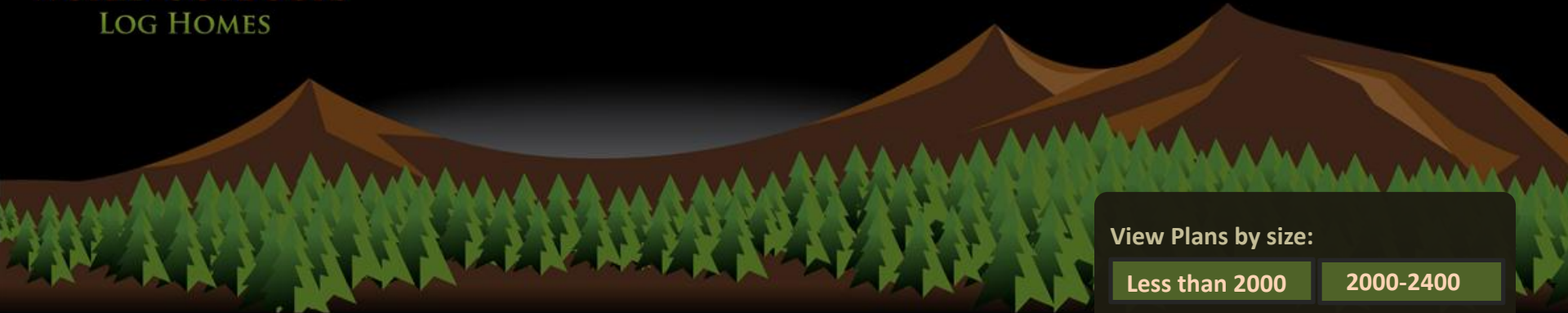

View Plans by size:

Less than 2000	2000-2400
2500- 3000	3000 +
Commercial	Garages

Cabin Designs > Garages > > All Plans

- Custom Design
- Log Home Plans
- ▶ Less than 1400
- ▶ 1400-2000
- ▶ 2000-2400
- ▶ 2400-3000
- ▶ Over 3000
- Garages
- ▶ All Plans
- Timber Frame
- Rustic Inspired



Description of Plan

Lorem ipsum dolor sit amet, consectetur adipiscing elit. Quisque consectetur, diam sit amet vestibulum tempor, erat qui aliquet lacus,





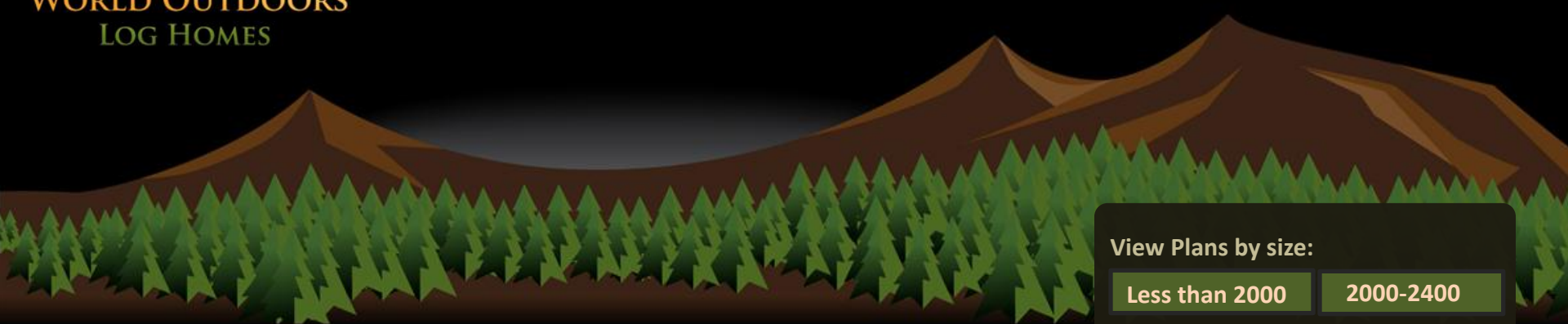

View Plans by size:

Less than 2000	2000-2400
2500- 3000	3000 +
Commercial	Garages

Cabin Designs > Timber Frames

- Custom Design
- Log Home Plans
- Garages
- Timber Frame
  - Under 2000
  - 2000-2400
  - 2400-3000
  - 3000-3500
  - Over 3500

Rustic Inspired

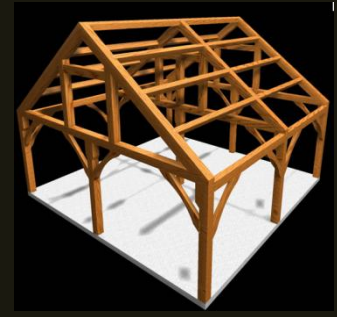
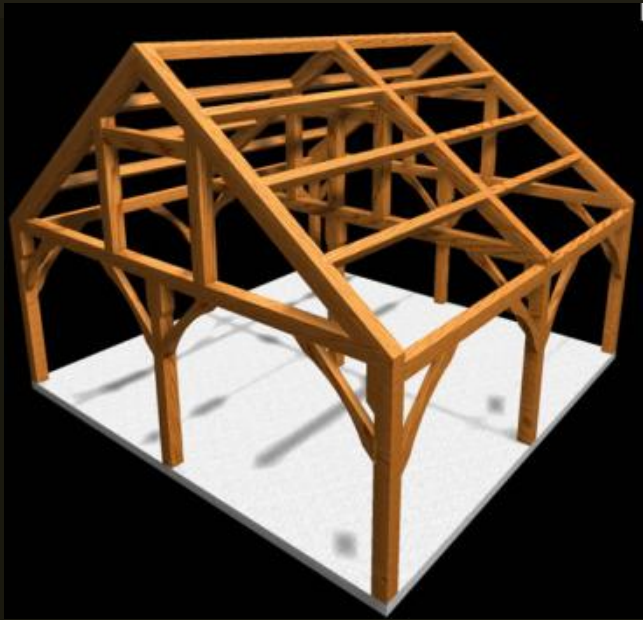

What are Timber Frame homes?

View Plans by size:

[Less than 2000](#)[2000-2400](#)[2500- 3000](#)[3000 +](#)[Commercial](#)[Garages](#)

Cabin Designs > Timber Frames > Under 2000

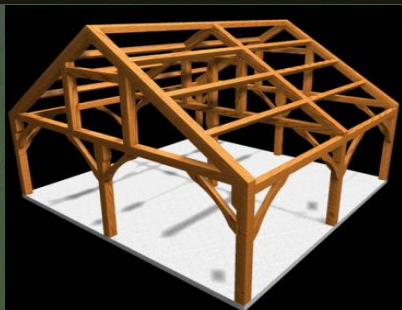
[Custom Design](#)[Log Home Plans](#)[Garages](#)[Timber Frames](#)[▶ Under 2000](#)[▶ 2000-2400](#)[▶ 2400-3000](#)[▶ 3000-3500](#)[▶ Over 3500](#)[Rustic Inspired](#)

Greece 1656 sq.ft.



Long Island 1661 sq.ft.



Clearwater 1670 sq.ft.





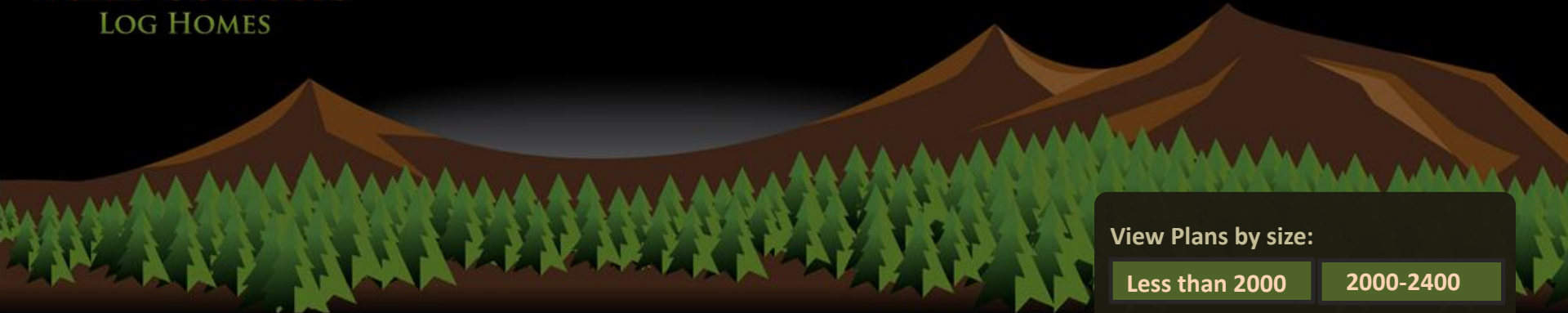

View Plans by size:

Less than 2000	2000-2400
2500- 3000	3000 +
Commercial	Garages

Cabin Designs > Timber Frames > Under 2000

- Custom Design
- Log Home Plans
- Garages
- Timber Frames
- ▶ Under 2000
- ▶ 2000-2400
- ▶ 2400-3000
- ▶ 3000-3500
- ▶ Over 3500
- Rustic Inspired
- Timber Homes



Description of Plan

Lorem ipsum dolor sit amet, consectetur adipiscing elit. Quisque consectetur, diam sit amet vestibulum tempor, erat qui aliquet lacus,



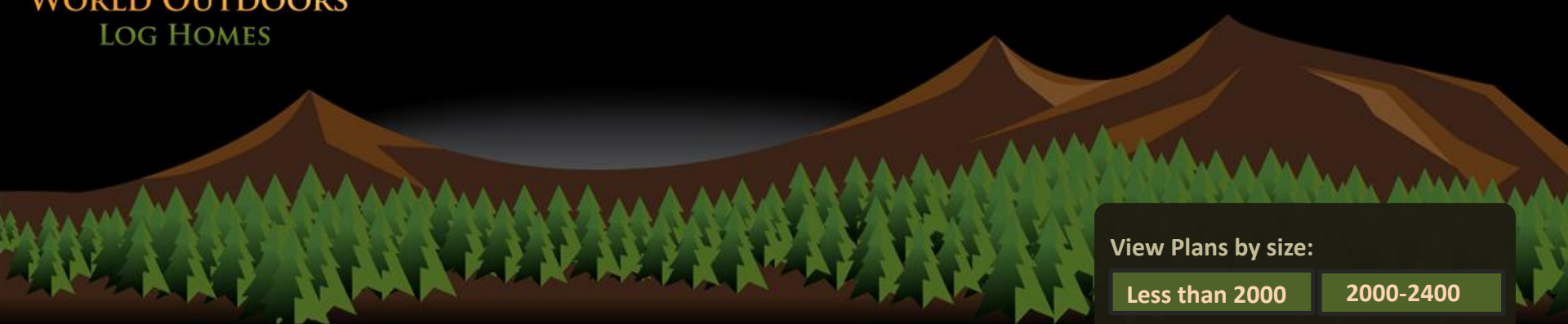

View Plans by size:

Less than 2000	2000-2400
2500- 3000	3000 +
Commercial	Garages

Cabin Designs > Rustic Inspired

- Custom Design
- Log Home Plans
- Garages
- Timber Frames
- Rustic Inspired
  - ▶ Less than 1400
  - ▶ 1400-2000
  - ▶ 2000-2400
  - ▶ 2400-3000
  - ▶ Over 3000
- Commercial Buildings



Rustic Inspired Homes





#### View Plans by size:

[Less than 2000](#)
[2000-2400](#)
[2500- 3000](#)
[3000 +](#)
[Commercial](#)
[Garages](#)

#### Cabin Designs > Rustic Inspired > 1400- 2000 sq. ft.

[Custom Design](#)
[Log Home Plans](#)
[Garages](#)
[Timber Frames](#)
[Rustic Inspired](#)
[▶ Less than 1400](#)
[▶ 1400-2000](#)
[▶ 2000-2400](#)
[▶ 2400-3000](#)
[▶ Over 3000](#)
[Commercial Buildings](#)

Long Island 1661 sq.ft.



Clearwater 1670 sq.ft.



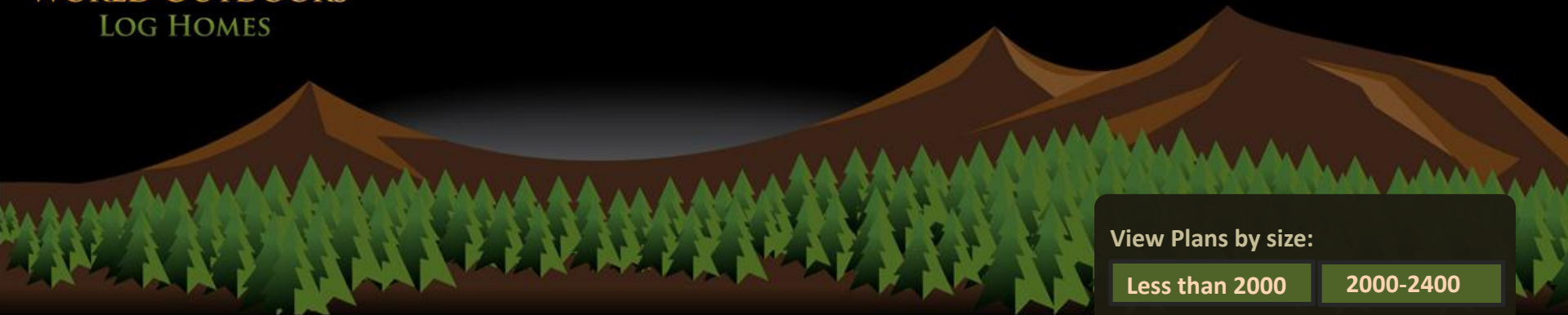

View Plans by size:

Less than 2000	2000-2400
2500- 3000	3000 +
Commercial	Garages

Cabin Designs > Rustic Inspired > 1400- 2000 sq. ft.

- Custom Design
- Log Home Plans
- Garages
- Timber Frames
- Rustic Inspired
  - ▶ Less than 1400
  - ▶ 1400-2000
  - ▶ 2000-2400
  - ▶ 2400-3000
  - ▶ Over 3000
- Commercial Buildings



Description of Plan

Lorem ipsum dolor sit amet, consectetur adipiscing elit. Quisque  
consectetur, diam sit amet vestibulum tempor, erat qui aliquet lacus,





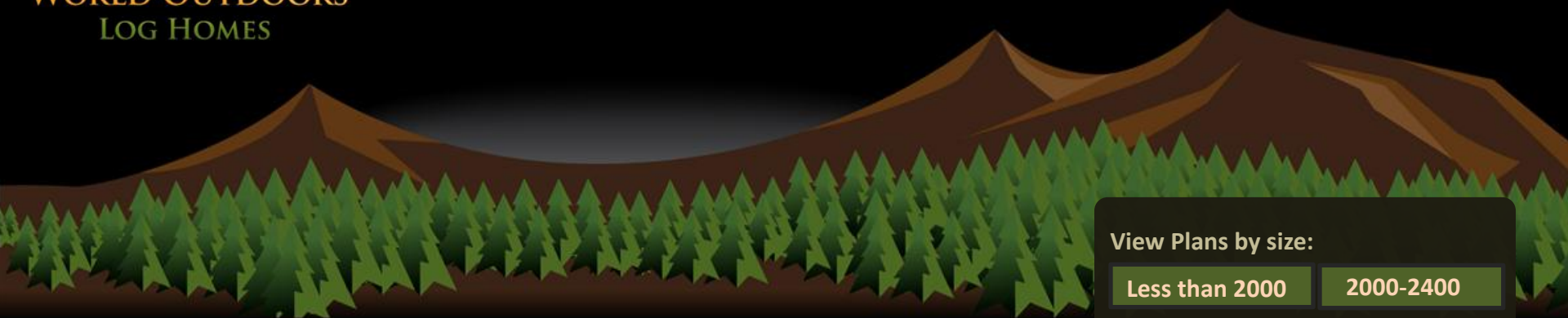

View Plans by size:

Less than 2000	2000-2400
2500- 3000	3000 +
Commercial	Garages

Cabin Designs > Commercial Buildings

- Custom Design
- Log Home Plans
- Garages
- Timber Frames
- ▶ Under 2000
- ▶ 2000-2400
- ▶ 2400-3000
- ▶ 3000-3500
- ▶ Over 3500
- Rustic Inspired
- Commercial Buildings

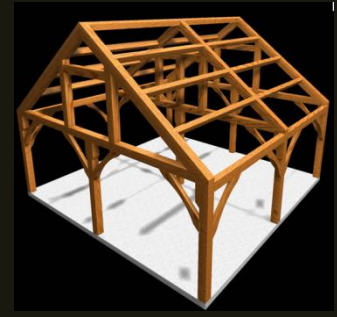

Commercial Buildings

Welcome to our extensive floor plans gallery. If you are having a



Building Materials Section  
(See top Nav and see Slide 1)

[Building Materials](#) > [Log Profiles](#)

[Log Profiles](#)

[Corner Styles](#)

[Log Packages](#)

[Engineered Logs](#)

[Siding & Stone](#)

[Pre-stacked Logs](#)

[Handrails](#)

[Store](#)

## Log Profiles

We buy and mill all of our logs at our facility here in Nebo, North Carolina. All of our logs are inspected and run through our climate controlled Kiln Dry System before being profiled through our planer.

Lorem ipsum dolor sit amet, consectetur adipiscing elit. Quisque consectetur, diam sit amet vestibulum tempor, erat dui aliquet lacus, vel elementum sapien lacus eu diam. Suspendisse fringilla sollicitudin nulla nec posuere. Nunc quis leo fermentum tellus scelerisque aliquam ac a magna. Morbi vitae enim felis.

All of our Log Homes are milled at our facility in Nebo, North Carolina, just 30 minutes East of Asheville. All of our logs are carefully inspected and taken into our kiln where they are dried in a climate controlled setting. We offer a

### View Plans by size:

[Less than 1400](#)

[1400-2000](#)

[2000- 2400](#)

[2400-3000](#)

[3000 +](#)

[Garages](#)



[Building Materials](#) > [Corner Styles](#)

[Log Profiles](#)[Corner Styles](#)[Log Packages](#)[Engineered Logs](#)[Siding & Stone](#)[Pre-stacked Logs](#)[Handrails](#)[Store](#)

## Corner Styles

We buy and mill all of our logs at our facility here in Nebo, North Carolina. All of our logs are inspected and run through our climate controlled Kiln Dry System before being profiled through our planer.

Lorem ipsum dolor sit amet, consectetur adipiscing elit. Quisque consectetur, diam sit amet vestibulum tempor, erat dui aliquet lacus, vel elementum sapien lacus eu diam. Suspendisse fringilla sollicitudin nulla nec posuere. Nunc quis leo fermentum tellus scelerisque aliquam ac a magna. Morbi vitae enim felis.

All of our Log Homes are milled at our facility in Nebo, North Carolina, just 30 minutes East of Asheville. All of our logs are carefully inspected and taken into our kiln where they are dried in a climate controlled setting. We offer a

### View Plans by size:

[Less than 1400](#)[1400-2000](#)[2000- 2400](#)[2400-3000](#)[3000 +](#)[Garages](#)



[Building Materials](#) > [Log Packages](#)

[Log Profiles](#)

[Corner Styles](#)

[Log Packages](#)

[Engineered Logs](#)

[Siding & Stone](#)

[Pre-stacked Logs](#)

[Handrails](#)

[Store](#)

## Log Packages

We buy and mill all of our logs at our facility here in Nebo, North Carolina. All of our logs are inspected and run through our climate controlled Kiln Dry System before being profiled through our planer.

Lorem ipsum dolor sit amet, consectetur adipiscing elit. Quisque consectetur, diam sit amet vestibulum tempor, erat dui aliquet lacus, vel elementum sapien lacus eu diam. Suspendisse fringilla sollicitudin nulla nec posuere. Nunc quis leo fermentum tellus scelerisque aliquam ac a magna. Morbi vitae enim felis.

All of our Log Homes are milled at our facility in Nebo, North Carolina, just 30 minutes East of Asheville. All of our logs are carefully inspected and taken into our kiln where they are dried in a climate controlled setting. We offer a

### View Plans by size:

[Less than 1400](#)

[1400-2000](#)

[2000- 2400](#)

[2400-3000](#)

[3000 +](#)

[Garages](#)

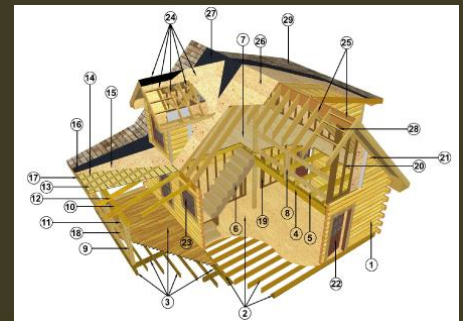

[Building Materials](#) > [Engineered Logs](#)

[Log Profiles](#)[Corner Styles](#)[Log Packages](#)[Engineered Logs](#)[Siding & Stone](#)[Pre-stacked Logs](#)[Handrails](#)[Store](#)

## Engineered Logs

Advantages and disadvantages of engineered logs. We buy and mill all of our logs at our facility here in Nebo, North Carolina. All of our logs are inspected and run through our climate controlled Kiln Dry System before being profiled through our planer.

Lorem ipsum dolor sit amet, consectetur adipiscing elit. Quisque consectetur, diam sit amet vestibulum tempor, erat dui aliquet lacus, vel elementum sapien lacus eu diam. Suspendisse fringilla sollicitudin nulla nec posuere. Nunc quis leo fermentum tellus scelerisque aliquam ac a magna. Morbi vitae enim felis.

All of our Log Homes are milled at our facility in Nebo, North Carolina, just 30 minutes East of Asheville. All of our logs are carefully inspected and taken into our kiln where they are kiln dried to meet the highest standards.

### View Plans by size:

[Less than 1400](#)[1400-2000](#)[2000- 2400](#)[2400-3000](#)[3000 +](#)[Garages](#)

Building Materials > Siding & Stone

[Log Profiles](#)[Corner Styles](#)[Log Packages](#)[Engineered Logs](#)[Siding & Stone](#)[Pre-stacked Logs](#)[Handrails](#)[Store](#)

## Siding & Stone

We buy and mill all of our logs at our facility here in Nebo, North Carolina. All of our logs are inspected and run through our climate controlled Kiln Dry System before being profiled through our planer.

Lorem ipsum dolor sit amet, consectetur adipiscing elit. Quisque consectetur, diam sit amet vestibulum tempor, erat dui aliquet lacus, vel elementum sapien lacus eu diam. Suspendisse fringilla sollicitudin nulla nec posuere. Nunc quis leo fermentum tellus scelerisque aliquam ac a magna. Morbi vitae enim felis.

All of our Log Homes are milled at our facility in Nebo, North Carolina, just 30 minutes East of Asheville. All of our logs are carefully inspected and taken into our kiln where they are dried in a climate controlled setting. We offer a

### View Plans by size:

[Less than 1400](#)[1400-2000](#)[2000- 2400](#)[2400-3000](#)[3000 +](#)[Garages](#)



[Building Materials](#) > [Pre-Stacked Logs](#)

#### View Plans by size:

[Less than 1400](#)[1400-2000](#)[2000- 2400](#)[2400-3000](#)[3000 +](#)[Garages](#)[Log Profiles](#)[Corner Styles](#)[Log Packages](#)[Engineered Logs](#)[Siding & Stone](#)[Pre-stacked Logs](#)[Handrails](#)[Store](#)

## Pre-Stacked Logs

We buy and mill all of our logs at our facility here in Nebo, North Carolina. All of our logs are inspected and run through our climate controlled Kiln Dry System before being profiled through our planer.

Lorem ipsum dolor sit amet, consectetur adipiscing elit. Quisque consectetur, diam sit amet vestibulum tempor, erat dui aliquet lacus, vel elementum sapien lacus eu diam. Suspendisse fringilla sollicitudin nulla nec posuere. Nunc quis leo fermentum tellus scelerisque aliquam ac a magna. Morbi vitae enim felis.

All of our Log Homes are milled at our facility in Nebo, North Carolina, just 30 minutes East of Asheville. All of our logs are carefully inspected and taken into our kiln where they are dried in a climate controlled setting. We offer a



[Building Materials](#) > [Handrails](#)

[Log Profiles](#)[Corner Styles](#)[Log Packages](#)[Engineered Logs](#)[Siding & Stone](#)[Pre-stacked Logs](#)[Handrails](#)[Store](#)

## Handrails

We buy and mill all of our logs at our facility here in Nebo, North Carolina. All of our logs are inspected and run through our climate controlled Kiln Dry System before being profiled through our planer.

Lorem ipsum dolor sit amet, consectetur adipiscing elit. Quisque consectetur, diam sit amet vestibulum tempor, erat dui aliquet lacus, vel elementum sapien lacus eu diam. Suspendisse fringilla sollicitudin nulla nec posuere. Nunc quis leo fermentum tellus scelerisque aliquam ac a magna. Morbi vitae enim felis.

All of our Log Homes are milled at our facility in Nebo, North Carolina, just 30 minutes East of Asheville. All of our logs are carefully inspected and taken into our kiln where they are dried in a climate controlled setting. We offer a

### View Plans by size:

[Less than 1400](#)[1400-2000](#)[2000- 2400](#)[2400-3000](#)[3000 +](#)[Garages](#)

## Building Materials Store Section



Building Materials > Store

Store

Logs

Log Siding

Lumber

Tongue & Groove

Windows

Doors

Fasteners

Other Building  
Materials



Here you will find a listing of products which we are able to offer directly from our mill in Nebo, NC. The menu on the left side of the page will guide you through our current offerings. If you don't see what you are looking for, please give us a call and we may be able to help you. Not all products are always listed as our inventory changes rapidly. If you would like a quote or need

View Plans by size:

Less than 1400

1400-2000

2000- 2400

2400-3000

3000 +

Garages

[Building Materials](#) > [Store](#) > [Logs](#)

[Store](#)

[Logs](#)

[Log Siding](#)

[Lumber](#)

[Tongue & Groove](#)

[Windows](#)

[Doors](#)

[Fasteners](#)

[Other Building  
Materials](#)



We offer a wide range of log profiles. Whether you like 6x8 or 6x12 'D' , 6x12 Dovetail with a Chink groove or Re-Saw Face, or even 10" rounds, it's your choice! Either way, you get the best logs with structure improving double-tongue & grooves which we tie together in a post and beam or dove tail system. All of our logs are inspected and run through our climate controlled Kiln Dry System before being profiled through our planer.

#### View Plans by size:

[Less than 1400](#)

[1400-2000](#)

[2000- 2400](#)

[2400-3000](#)

[3000 +](#)

[Garages](#)

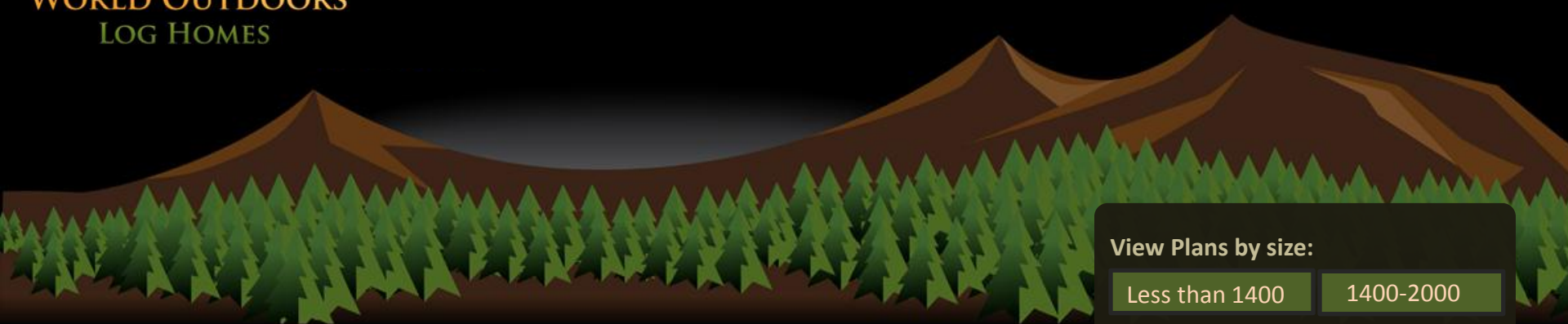

View Plans by size:

Less than 1400	1400-2000
2000- 2400	2400-3000
3000 +	Garages

Building Materials > Store > Log Siding

- Store
- Logs
- Log Siding
- Lumber
- Tongue & Groove
- Windows
- Doors
- Fasteners
- Other Building Materials



Log siding is a great way to get an authentic log home look without the log home price tag. Full logs are expensive to buy, harder to install, and require more maintenance over time. Log Siding is very easy to install, produces less wasted materials, and provides a better insulating quality when installed on a conventional built wall—saving you money in the long run as well.



#### View Plans by size:

[Less than 2000](#)
[2000-2400](#)
[2500- 3000](#)
[3000 +](#)
[Commercial](#)
[Garages](#)

#### Store

[Store](#)
[Logs](#)
[Log Siding](#)
[Lumber](#)
[Tongue & Groove](#)
[Windows](#)
[Doors](#)
[Fasteners](#)
[Other Building Materials](#)

#### 4x10 S4S

4x10x8' S4S	\$23.00
4x10x10' S4S	\$29.00
4x10x12' S4S	\$34.00
4x10x14' S4S	\$40.00
4x10x16' S4S	\$51.00
4x10x18' S4S	\$61.00
4x10x20' S4S	\$77.00
4x10x22' S4S	\$88.00
4x10x24' S4S	\$100.00



#### 4x12 S4S

4x12x8' S4S	\$29.00
4x12x10' S4S	\$36.00
4x12x12' S4S	\$43.00
4x12x14' S4S	\$50.00
4x12x16' S4S	\$64.00
4x12x18' S4S	\$78.00
4x12x20' S4S	\$90.00
4x12x22' S4S	\$100.00
4x12x24' S4S	\$120.00



#### 4x4 S4S

4X4X8' S4S	\$13.00
4X4X10' S4S	\$15.00
4X4X12' S4S	\$17.00
4X4X14' S4S	\$19.00
4X4X16' S4S	\$22.00
4X4X18' S4S	\$26.00

## Pricing for White Pine S4S

### White Pine S4S

1x12 S4S LFT \$1.35

2x12 S4S LFT \$1.98

### 4x10 S4S

4x10x8' S4S \$23.00

4x10x10' S4S \$29.00

4x10x12' S4S \$34.00

4x10x14' S4S \$40.00

4x10x16' S4S \$51.00

4x10x18' S4S \$61.00

4x10x20' S4S \$77.00

4x10x22' S4S \$88.00

4x10x24' S4S \$100.00

### 4x12 S4S

4x12x8' S4S \$29.00

4x12x10' S4S \$36.00

4x12x12 S4S \$43.00

4x12x14 S4S \$50.00

4x12x16' S4S \$64.00

4x12x18' S4S \$78.00

4x12x20' S4S \$90.00

4x12x22' S4S \$100.00

4x12x24 S4S \$120.00

### 4x4 S4S

4X4X8' S4S \$13.00

4X4X10' S4S \$15.00

4X4X12' S4S \$17.00

4X4X14' S4S \$19.00

4X4X16' S4S \$22.00

4X4X18' S4S \$26.00

### 4x6 S4S

4x6x8' S4S \$14.50

4x6x10' S4S \$17.00

4x6x12' S4S \$19.50

4x6x14' S4S \$26.50

4x6x16' S4S \$34.50

4x6x18' S4S \$42.00

4x6x20' S4S \$53.00

4x6x22' S4S \$65.00

4x6x24' S4S \$80.00

### 4x8 S4S

4x8x8' S4S \$17.00

4x8x10' S4S \$23.50

4x8x12' S4S \$26.75

4x8x14' S4S \$32.75

4x8x16' S4S \$46.25

4x8x18' S4S \$52.75

4x8x20' S4S \$62.00

4x8x22' S4S \$70.00

4x8x24' S4S \$85.00

### 6x10 S4S

6x10x8' S4S \$33.00

6x10x10' S4S \$42.00

6x10x12' S4S \$49.00

6x10x14' S4S \$58.00

6x10x16' S4S \$70.00

6x10x18' S4S \$88.00

6x10x20' S4S \$100.00

6x10x22' S4S \$117.00

6x10x24' S4S \$132.00

### 6x12 S4S

6x12x8' S4S \$46.00

6x12x10' S4S \$54.00

6x12x12 S4S \$62.00

6x12x14' S4S \$75.00

6x12x16' S4S \$95.00

6x12x18' S4S \$118.00

6x12x20' S4S \$130.00

6x12x22' S4S \$158.00

6x12x24' S4S \$175.00

### 6x6 S4S

6x6x8' S4S \$19.00

6x6x10' S4S \$24.00

6x6x12' S4S \$29.00

6x6x14' S4S \$33.50

6x6x16' S4S \$41.00

6x6x18' S4S \$53.00

6x6x20' S4S \$61.00

6x6x22' S4S \$71.00

6x6x24' S4S \$85.00

### 6x8 S4S

6x8x8' S4S \$25.50

6x8x10' S4S \$32.00

6x8x12' S4S \$40.00

6x8x14' S4S \$47.00

6x8x16' S4S \$60.00

6x8x18' S4S \$75.50

6x8x20' S4S \$88.00

6x8x22' S4S \$95.00

6x8x24' S4S \$125.00

[Building Materials](#) > [Store](#) > [Tongue & Groove](#)

Store

Logs

Log Siding

Lumber

Tongue & Groove

Windows

Doors

Fasteners

Other Building  
Materials



Tongue and Groove is a type of siding in which a projecting rib on the edge of one board fits into a groove in the edge of an adjacent board. Tongue and Groove is commonly used for siding and

#### View Plans by size:

Less than 1400

1400-2000

2000- 2400

2400-3000

3000 +

Garages



[Building Materials](#) > [Store](#) > [Windows](#)

Store

Logs

Log Siding

Lumber

Tongue & Groove

Windows

Doors

Fasteners

Other Building  
Materials



#### View Plans by size:

Less than 1400

1400-2000

2000- 2400

2400-3000

3000 +

Garages

We use only PlyGem windows and patio doors on all our construction. We don't want to skimp and neither should you. Windows are a reflection of style and a reflection of home. Make the best

[Building Materials](#) > [Store](#) > [Doors](#)

View Plans by size:

[Less than 1400](#)

[1400-2000](#)

[2000- 2400](#)

[2400-3000](#)

[3000 +](#)

[Garages](#)

[Store](#)

[Logs](#)

[Log Siding](#)

[Lumber](#)

[Tongue & Groove](#)

[Windows](#)

[Doors](#)

[Fasteners](#)

[Other Building  
Materials](#)



Our hand-crafted, Solid Hardwood Doors are built to order by a small, family-owned company.

[Building Materials](#) > [Store](#) > [Fasteners](#)

[Store](#)

[Logs](#)

[Log Siding](#)

[Lumber](#)

[Tongue & Groove](#)

[Windows](#)

[Doors](#)

[Fasteners](#)

[Other Building  
Materials](#)



#### View Plans by size:

[Less than 1400](#)

[1400-2000](#)

[2000- 2400](#)

[2400-3000](#)

[3000 +](#)

[Garages](#)

OlyLog is the first threaded log home fastener which requires no predrilling and is ACQ approved.



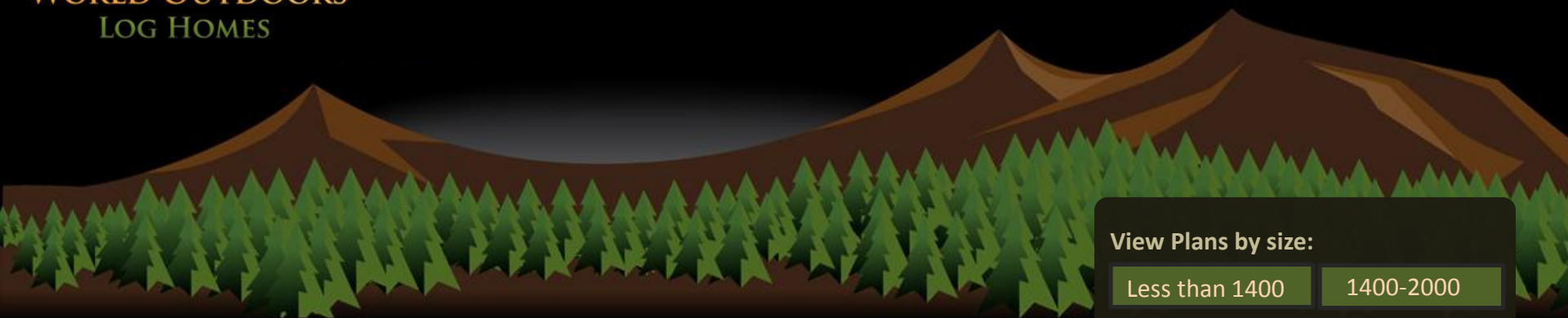

View Plans by size:

Less than 1400	1400-2000
2000- 2400	2400-3000
3000 +	Garages

Building Materials > Store > Other Building Materials

- Store
- Logs
- Log Siding
- Lumber
- Tongue & Groove
- Windows
- Doors
- Fasteners
- Other Building Materials



We use only PlyGem windows and patio doors on all our construction. We don't want to skimp and neither should you. Windows are a reflection of style and a reflection of home. Make the best choice for your log home.

Photo Gallery  
(See top Nav and see Slide 1)

#### View Plans by size:

[Less than 2000](#)
[2000-2400](#)
[2500- 3000](#)
[3000 +](#)
[Commercial](#)
[Garages](#)

#### Photo Gallery > Exterior

[Exterior](#)
[Interior](#)
[Construction](#)
[Current Projects](#)

Greece 1656 sq.ft.



Long Island 1661 sq.ft.



Clearwater 1670 sq.ft.



Clicking on one image will open a popup with



Photo Gallery > Interior

Exterior

Interior

Construction

Current  
Projects



Clicking on  
one image  
will open a  
popup with

View Plans by size:

Less than 2000

2000-2400

2500- 3000

3000 +

Commercial

Garages

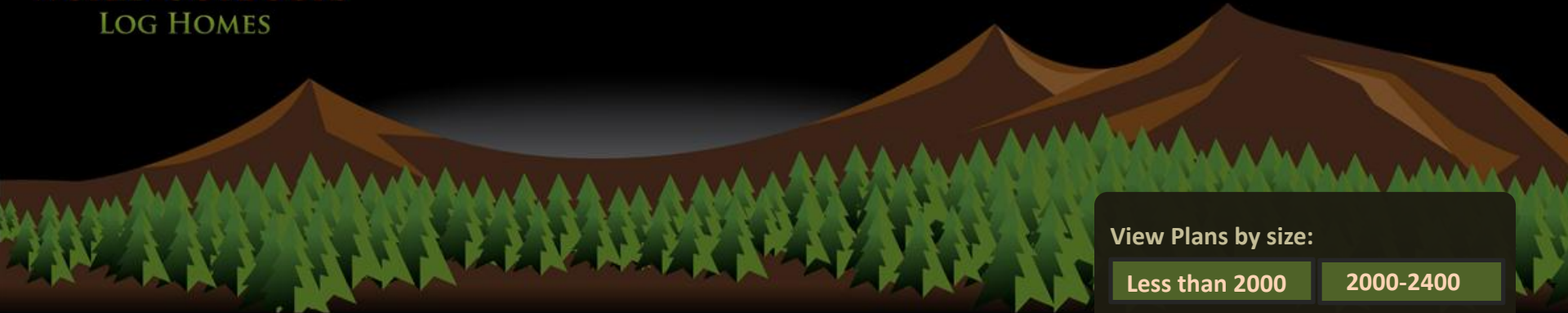

View Plans by size:

- |                |           |
|----------------|-----------|
| Less than 2000 | 2000-2400 |
| 2500- 3000     | 3000 +    |
| Commercial     | Garages   |

Photo Gallery > Construction

Exterior

Interior

Construction

Current  
Projects



Clicking on  
one image  
will open a  
popup with



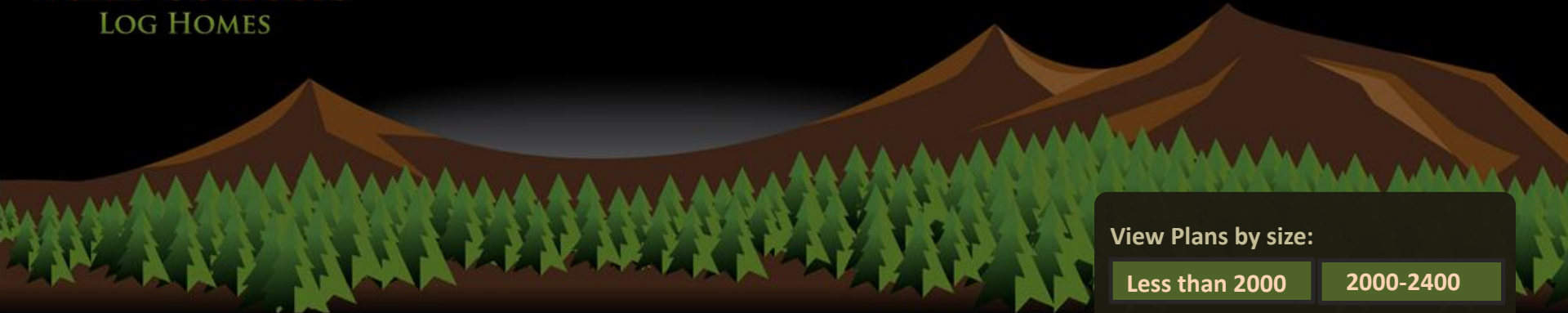

View Plans by size:

Less than 2000	2000-2400
2500- 3000	3000 +
Commercial	Garages

Photo Gallery > Current Projects

- Exterior
- Interior
- Construction
- Current Projects



Clicking on one image will open a popup with



Custom Cabinets  
(See top Nav and see Slide 1)

#### View Plans by size:

[Less than 2000](#)[2000-2400](#)[2500- 3000](#)[3000 +](#)[Commercial](#)[Garages](#)

#### Custom Cabinets

##### Custom Cabinets

[Photos](#)[Wood Species](#)[Door Styles](#)[Color Options](#)

Post and Beam, Timber Frame and Log Home Floor Plans

Custom Cabinets > Photos

Custom Cabinets

Photos

Wood Species

Door Styles

Color Options



View Plans by size:

Less than 1400

1400-2000

2000- 2400

2400-3000

3000 +

Garages



Custom Cabinets > Wood Species

Custom Cabinets

Photos

Wood Species

Door Styles

Color Options

## Wood Species

We offer a variety of colors and grain patterns like hickory, pine, cherry, maple... etc



### Hickory

will vary “wildly” in color; ranging from a blond hue to dark brown, with mineral streaks, knots and burls emphasizing the natural growth of the tree. Hickory is generally admired for its dramatic variations in color and grain pattern.

[More](#)

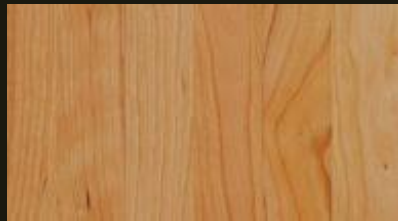

### Cherry

an elegant hardwood, defined by soft grain patterns and rich tonality. In its natural state the specie may exhibit deep reddish-brown heartwood, while having areas that are slightly yellowish, pink, or even gray. These variations will be more visible in product finished in lighter colors.

### View Plans by size:

Less than 1400

1400-2000

2000- 2400

2400-3000

3000 +

Garages

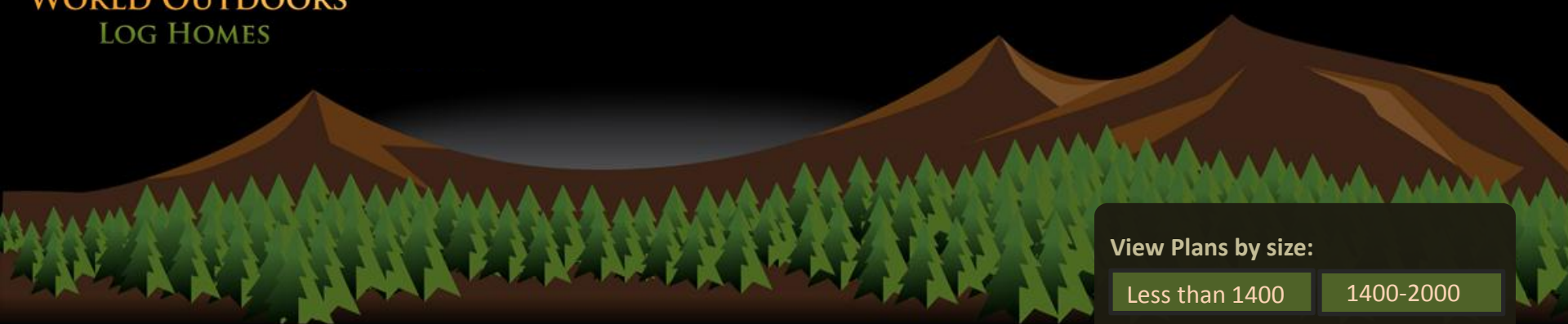

View Plans by size:

Less than 1400	1400-2000
2000- 2400	2400-3000
3000 +	Garages

Custom Cabinets > Wood Species > Cherry

- Custom Cabinets
- Photos
- Wood Species
- Door Styles
- Color Options

## Wood Species



### Cherry

Cherry is an exceptionally elegant hardwood, defined by soft grain patterns and rich tonality. In its natural state the specie may exhibit deep reddish-brown heartwood, while having areas that are

I be  
for  
.

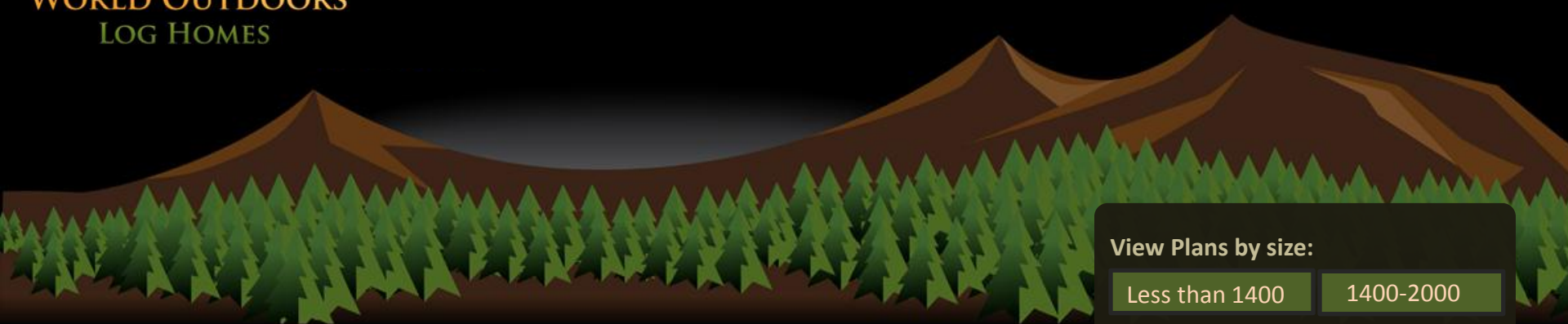

View Plans by size:

Less than 1400	1400-2000
2000- 2400	2400-3000
3000 +	Garages

Custom Cabinets > Door Styles

- Custom Cabinets
- Photos
- Wood Species
- Door Styles
- Color Options

Door Styles

Here are a few of our most popular styles of cabinet doors. Lorem ipsum dolor sit amet, consectetur adipiscing elit. Quisque consectetur, diam sit amet vestibulum tempor, erat dui aliquet lacus, vel elementum sapien lacus eu diam. Suspendisse fringilla sollicitudin nulla nec posuere. Nunc quis leo fermentum tellus scelerisque aliquam ac a magna. Morbi vitae enim felis.





Custom Cabinets > Color Options

Custom Cabinets

Photos

Wood Species

Door Styles

Color Options

## Maple

Maple's general coloration ranges from a yellowish-white to a light tan shade. Mineral streaks are common in Maple and turn darker when stained.



Clear



Colonial



Walnut



Blush



Rich Brandy



Fruitwood

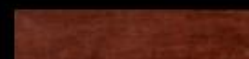
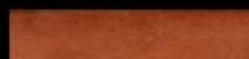

### View Plans by size:

Less than 1400

1400-2000

2000- 2400

2400-3000

3000 +

Garages